

1 2 3 4

A

B

C

D

E

F

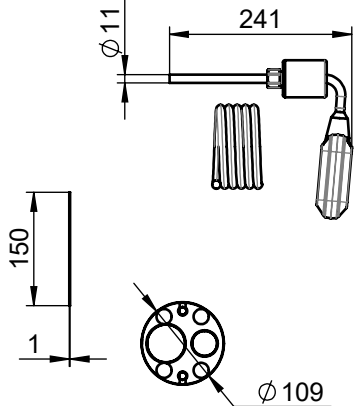
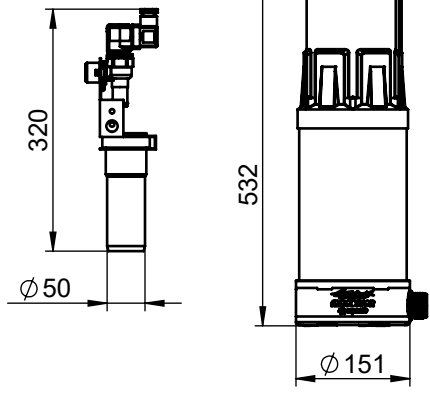
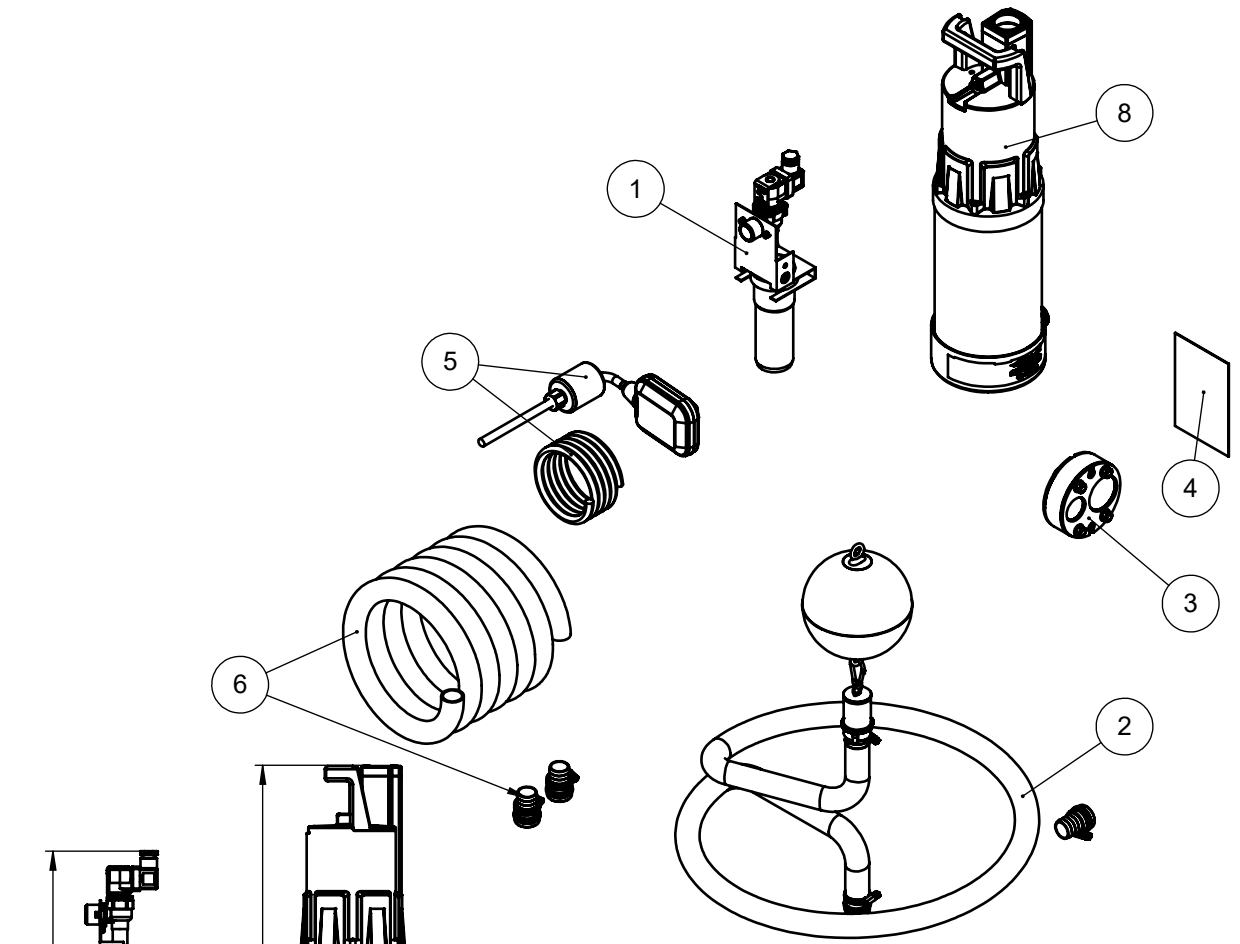

Specification / Technische Daten:
 Maximum head / Max. Foerderhoehe: 45 m
 Maximum output / Max. Foerdermenge: 100 l/min
 Maximum power / Max. Leistung: 1000 W
 Maximum working pressure / Max. Arbeitsdruck: 4,5 bar
 Voltage / Spannung: 230 V
 Frequency / Frequenz: 50 Hz

Details:
 Including 15 m connection cable /
 Inklusive 15 m Anschlusskabel

Pos.	Item-No.	Index	Item name	QTY.
1	1015851	001	Drinking water feeder	1
2	1208529	002	Floating suction filter for GAP X120 with 1m hose	1
3	1015833	001	Seal for through-the-wall-connections DN 110 / 1x 32, 1x 50 mm	1
4	1027614	001	Labelling kit	1
5	1067269	001	Float switch, set	1
6	1067236	002	5m hose with adapter	1
7	1067280	001	Hose connector 1 inch	1
8	1203110	003	Clean water pressure pump X120	1

material number: 2001139
 local article number: 103152

 ACO GmbH Am Ahlmannkai 24782 Büdelsdorf www.aco.com	drawing-no.:	index:	documenttype:
	1257092	002	marketing drw.
created by:	reviewed by:	projection:ISO-E	scale:
			1:10

title:
 ACO Rain4me
 Drinking water feeder, set
 TW-Nachspeisung, Set

serial-released

The reproduction, distribution and utilization of this document as well as the communication of its contents to others without express authorization is prohibited. Offenders will be held liable for the payment of damages. All rights reserved in the event of the grant of a patent, utility model or design. Observe copyright by ISO 16016

release date: 13.05.2024

sheet: 1/1

Software 2018 - DIN A4 - Version 1.8